

Background

- Urinary tract infection (UTI) is the most common healthcare-associated infection (HAI) which accounts for up to 36% of all HAIs
- Catheter-associated urinary tract infections (CAUTIs) account for up to 80% of UTIs
- The external urine collection device (UCD) is a great alternative to indwelling catheters

*They should be considered for prevention of hospital-acquired infections

- **Educating employees** and increasing the use of external UCDs decreases the incidence of HAIs

And can assist with:

- Monitoring continuous output
- Maintaining and improving skin integrity
- Maintaining patient dignity
- Improving nurse satisfaction

Practice Change

- Assess compliance and knowledge of UCD practices by the RN staff of NLMC before and after providing UCD education and demonstration
- Observe for improved knowledge and understanding of UCD practices by comparing pre/post surveys before and UCD education

Purpose/Benefits

- The direct benefit for staff is:
 - Enhanced knowledge
 - Increased confidence in selecting and implementing appropriate nursing interventions
 - Increased satisfaction by decreasing episodes of incontinence

Methods

Methods:

- Perform education at skills fair and provide informational/educational materials to staff
- Pre/Post Purewick Survey at skills fair

Procedure:

- Pre UCD System Survey at Skills Fair
- Present educational information to staff through informational/educational materials such as posters, verbal instructions and demonstrations at skills fair
- Post UCD System Survey at Skills Fair following education

Survey

Pre-Survey

1. How confident do you feel in your ability to use a UCD prior to skills fair education?
 - a. Rate your confidence from 1 to 5 (1=No confidence, 5=Expert)
2. When is a Purewick indicated? Please circle correct answers
 - a. Urinary retention
 - b. Urinary incontinence and/or frequent urination
 - c. Post Surgical Immobility
 - d. Agitation, confusion, uncooperative, combative
 - e. Menstruation
 - f. Difficulty using a bedpan
 - g. Frequent bowel incontinence
 - h. Skin breakdown at site
 - i. Skin irritation or injury related to incontinence or briefs
 - j. Bedrest

Post Survey (How do you feel after skills fair?)

1. I can identify the appropriate indications for using an external UCD? (Rate on a scale 1 to 5. 1= Unable, 5= Able to identify appropriate indications)
2. Do you feel as though you need further education? Rate on a scale of 1 to 5. (1= No further education, 5 = A lot more education)
 - a. If 2 or above, please elaborate on where the need for further education is.
3. How likely are you to use a UCD, when indicated in your own practice. (1 = Not likely, 5 = Very likely)

Education Provided

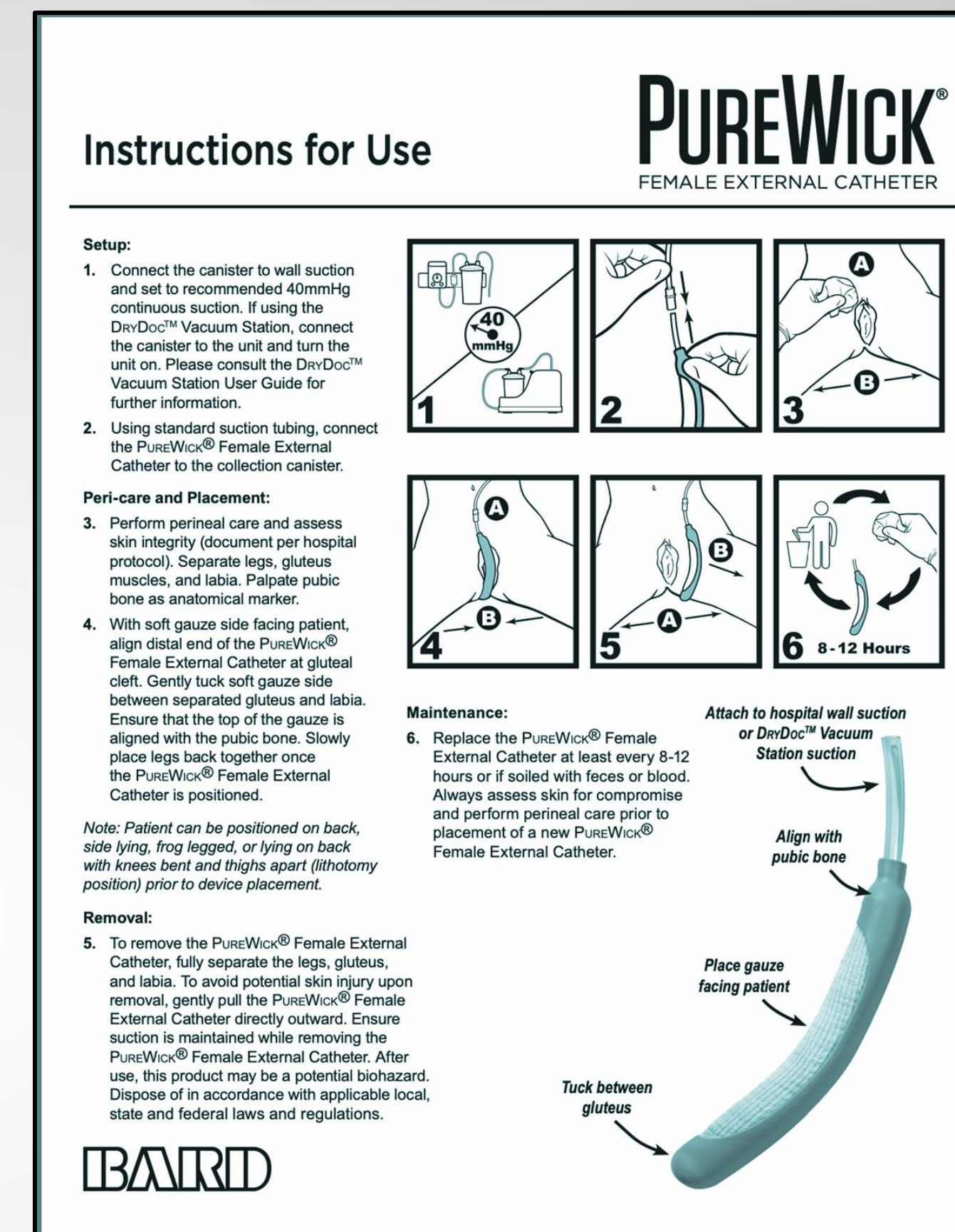

Survey Results n=38

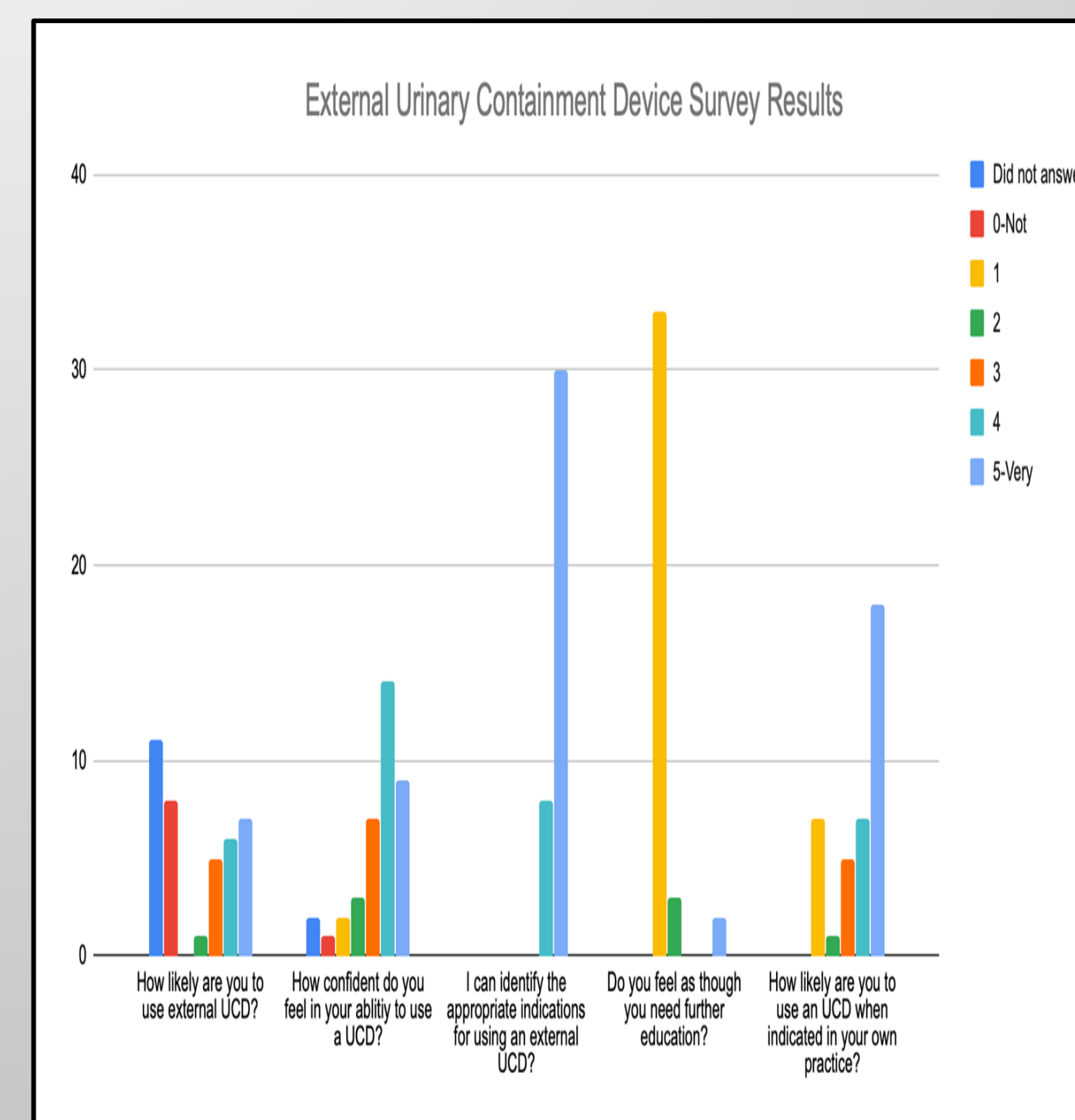

Summary/Discussion

- Overall there were 38 participants (n=38).
- When comparing pre-survey question 1 to post-survey question 3 there was a 257% increase regarding confidence/likelihood of using Purewick
- Continue to provide UCD education to staff to maintain competency and confidence

Barriers:

- Limited time to focus on UCD education alone during skills fair
- Survey had limitations in comparing before and after answers of participants
- Unit variability was not taken into consideration

Conclusion

- By providing education nurses increase their confidence and are more likely to use UCDs in their own practice
- Barriers to using UCDs include lack of education, availability and type of nursing being provided

References

- Bard. (2015). *Fitting the Sheath. Fitting the Sheath*. Stewartville, MN.
- Bard, DryDoc, & PureWick. (2017). *Purewick Female External Catheter: Instructions for Use. Purewick Female External Catheter: Instructions for Use*. El Cajon, CA.
- Beeson, T., & Davis, C. (2018). Urinary Management With an External Female Collection Device. *Journal of Wound, Ostomy and Continence Nursing*, 45(2), 187–189. doi: 10.1097/won.0000000000000417
- Hopper, E. (2019). Express Medical Supply Blog. Retrieved from <https://www.exmed.net/blog/expressmedicalsupply/post/2019/01/08/product-guide-how-to-choose-an-external-condom-catheter.aspx>.
- Parker, V., Giles, M., Graham, L., Suthers, B., Watts, W., O'Brien, T., & Searles, A. (2017). Avoiding inappropriate urinary catheter use and catheter-associated urinary tract infection (CAUTI): a pre-post control intervention study. *BMC Health Services Research*, 17(1). Doi: 10.1186/s12913-017-2268-2